

# S-SERIES

## Translating Screw Jack 100kN

### Performance

Screw Jack Model <sup>4</sup>	S-100		
Capacity	kN	100	
Lead Screw <sup>1</sup>	Diameter (mm)	55	
	Lead (mm)	12   24	
Gear Ratios	Option 1	8:1	
	Option 2	24:1	
	Option 3	6:1 [AOR]	
4 x Turns of worm for travel of lead screw	Option 1	6mm   12mm	
	Option 2	2mm   4mm	
	Option 3	8mm   16mm	
Maximum Input Power (kW)	Option 1	3.75	
	Option 2	1.125	
	Option 3	3.75	
Start up torque at full load (Nm) <sup>2</sup>	Option 1	111   151	
	Option 2	57   77	
	Option 3	140   190	
Maximum Through Torque (Nm) <sup>7</sup>	Option 1	347.7	
	Option 2	181.5	
	Option 3	347.7	
Static Efficiency <sup>3</sup>	Option 1	0.214   0.317	
	Option 2	0.140   0.207	
	Option 3	0.227   0.336	
Dynamic Efficiency <sup>3</sup>	Option 1	50rpm	0.272   0.389
	Option 1	750rpm	0.315   0.450
	Option 1	1500rpm*	0.328   0.468
	Option 2	50rpm	0.188   0.269
	Option 2	750rpm	0.252   0.359
	Option 2	1500rpm*	0.274   0.391
	Option 3	50rpm	0.285   0.407
	Option 3	750rpm	0.324   0.462
	Option 3	1500rpm*	0.336   0.479
Maximum Input Speed (rpm)	-	3000	
Gear Case Material	-	SG Iron	
Weight (kg) – stroke = 150mm	ST100	47.7	
	SR100	53.9	
Weight (kg) – per extra 25mm	ST100	0.47	
	SR100	0.36	

### SMT0100 Closed Height

Threaded End
Top Plate
Clevis End
Fork End
Rod End

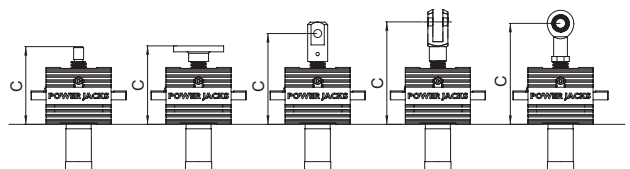

Closed Height 'C'	Threaded End	Top Plate	Clevis End	Fork End	Rod End
ST100	224	224	269	328	309
Stroke (mm)	With Bellow Boots [B]				
0 - 300	224	224	269	328	309
301 - 600	238	238	283	342	323
601 - 1050	256	256	301	360	341
1051 - 1500	275	275	320	379	360
1501 - 1800	295	295	340	399	380

### SMT0100 Stop Nut



Stop nut provides a full power mechanical stop at the end of the lead screw. To be used as a safety feature in emergency conditions.

$$SN = \text{Stroke} + 37\text{mm}$$

### SMT0100-C00

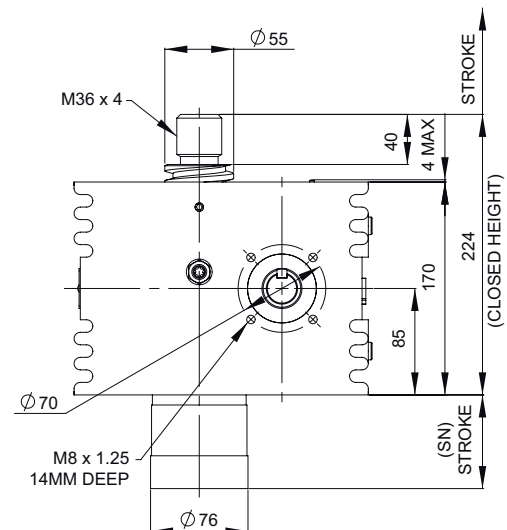
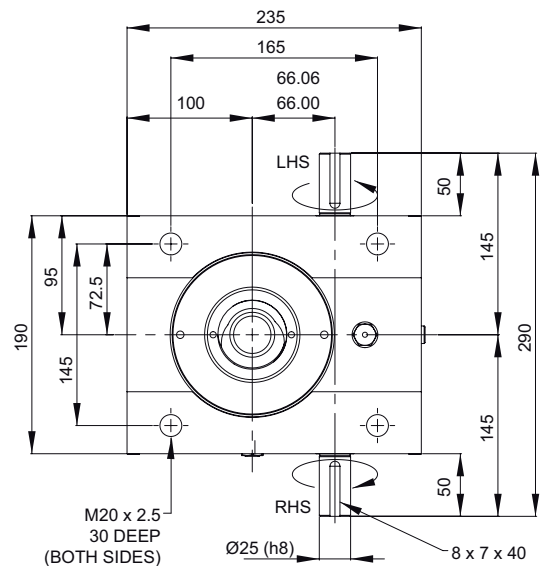

#### Note:

1. All dimension in millimetres unless otherwise stated.
2. Designs subject to change without notice.

# S-SERIES

Rotating Screw Jack 100kN

SMR0100-C00

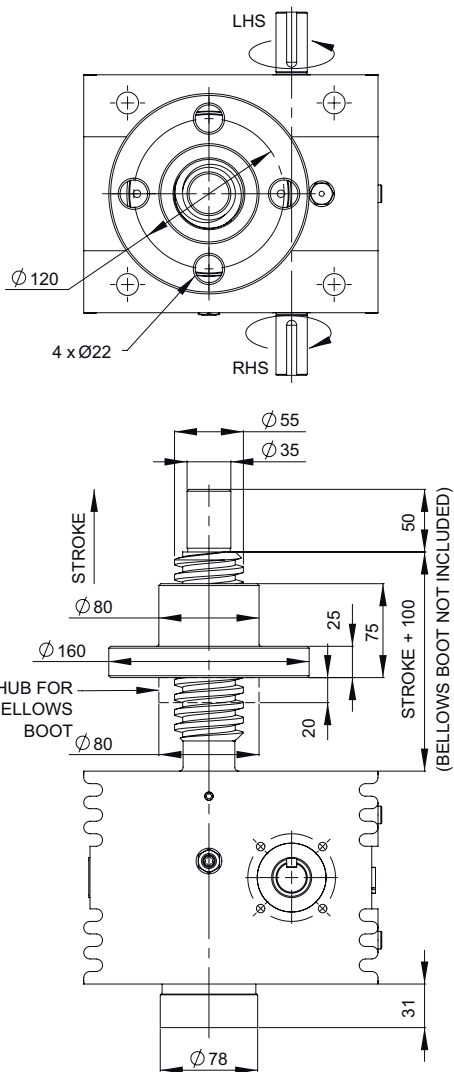
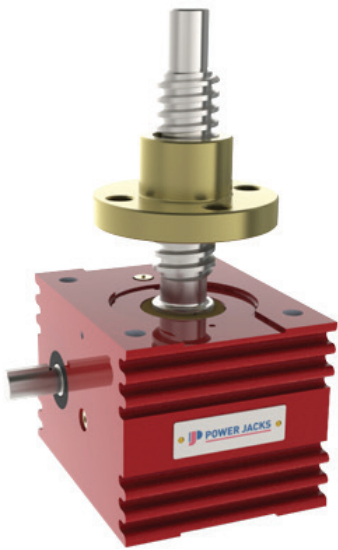

## Column Strength

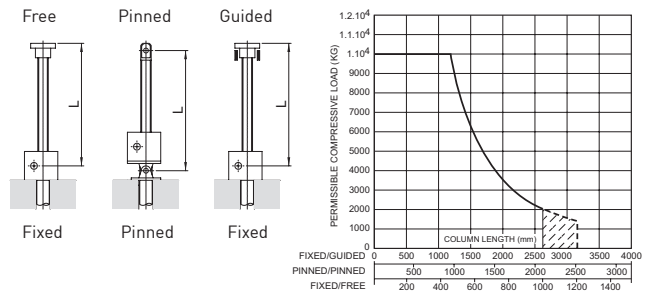

## Critical Screw Speed

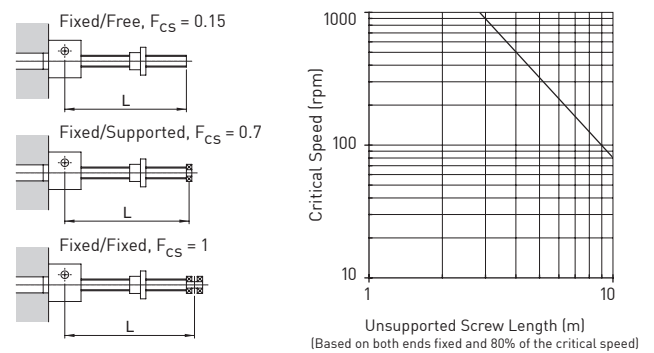

## Bellows Boot

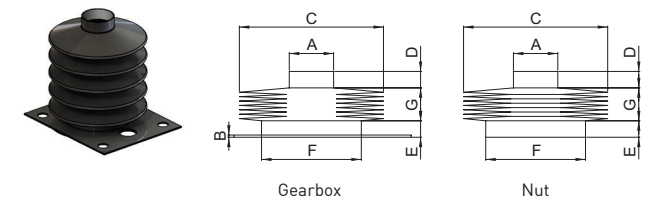

	ØA	B	ØC	D	E	ØF
SMT0100	65	3	150	10	10	70
SMR0100	80	3	150	10	15	70

Stroke	1 - 300	301 - 600	601 - 1050	1051 - 1500	1501 - 1800
G	14	28	46	65	85*

\*control tapes fitted ØC=170

## Accessories & Options

