



Running Line Tensiometer



Key Uses

- Line tension (load) monitoring
- Speed monitoring
- Payout (distance) monitoring
- For wire rope, synthetic rope, dynema, fibre optic and cable systems
- In subsea, offshore and onshore applications

For winch, crane, tow, laying and tensioning applications, use Power Jacks Running Line Tensiometer

Features

- 20 Running Line Tensiometer designs
- Line Diameters from Ø10mm to Ø100mm
- Line Capacities up to 120Te
- Rugged design for operation in the most extreme environments
- Simple and quick access for line/rope fitting
- Hazardous area ATEX models available for all environments
- Marinised design ensures corrosion prevention in Offshore environments.
- Line mounted supplied with tether/swivel mount as standard with the options for bolt on feet or trunnion mount (pivot on 2 feet) Custom mounts available on request.
- Wireless options available
- Data logging software available
- Reliable load monitoring designed by Power Jacks in the UK

Line Monitor Display

- Matched for use with our Running Line Monitor.
- Simple to use keypad with multidigit, 9mm LCD display.
- Calibrated in Tonne with kg resolution accuracy (alternative weighing units on request eg kg, lb, kN)
- Polycarbonate housing with Stainless Steel frame.
- Vandal proof switches.
- 9.5mm Character LCD display.
- 7-40 VDC power supply with low power consumption.
- Fully adjustable bracket
- Full data logging available.



Design Detail

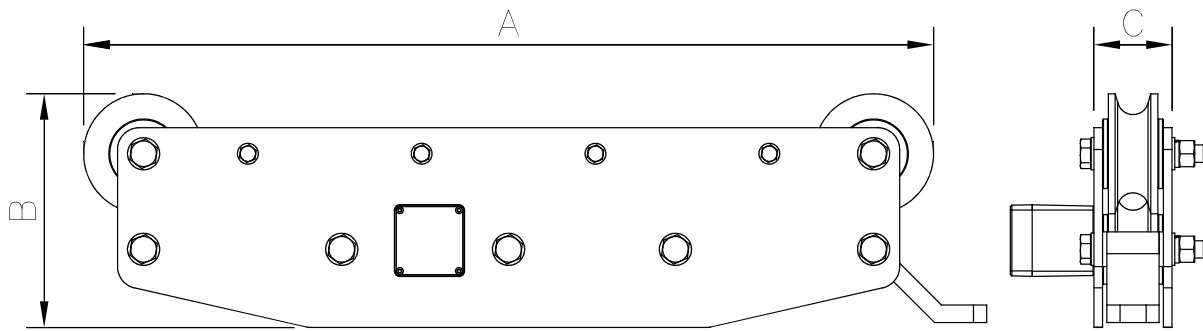

Model	Rope Diameter (mm)	Working Tension (Te)	A (mm)	B (mm)	C (mm)	Weight (kg)
RLT-1-10	10	9	722	250	162	21.5
RLT-1-13	13	9	722	250	162	21.5
RLT-1-16	16	9	722	250	162	21.5
RLT-1-19	19	9	722	250	162	21.5
RLT-1-22	22	9	722	250	162	21.5
RLT-1-25	25	9	722	250	162	21.5
RLT-2-22	22	22.5	810	270	186	37
RLT-2-25	25	22.5	810	270	186	37
RLT-2-28	28	22.5	810	270	186	37
RLT-3-32	32	45	963	297	188	56
RLT-3-35	35	45	963	297	188	56
RLT-3-38	38	45	963	297	188	56
RLT-3-40	40	45	963	297	188	56
RLT-4-42	42	64	1029	296	198	77
RLT-4-44	44	64	1029	296	198	77
RLT-4-48	48	64	1029	296	198	77
RLT-8-52	52	90	1250	426	185	125
RLT-8-66	66	90	1250	426	185	125
RLT-8-68	68	120	1703	488	278	187
RLT-8-100	100	120	1703	488	278	187

Data Logging

- All Wireless Units can be transmitted to Local PC for immediate displaying on screen.
- Live logging and graph display
- Exportable to Excel
- User can plot graph, capture peak loads and analyse test for producing to end clients and test presentations.
- MS Windows based
- Standard product uses discrete USB powered Base station so that no hardware installation required.



POWER JACKS Ltd
Load Monitoring Solutions
Balmacassie Commercial Park
Ellon, AB41 8BX
Scotland (UK)

Tel: +44 (0)1358 285100
www.powerjacks.com
LMS@powerjacks.com



All rights reserved by Power Jacks Limited. May not be copied in whole or in part.

©Power Jacks Limited 2014, Aberdeenshire, Scotland, United Kingdom.

Dimensions & values subject to change without notice.